

Installing Clips on Pre-Drilled Panels for Concealed Attachments

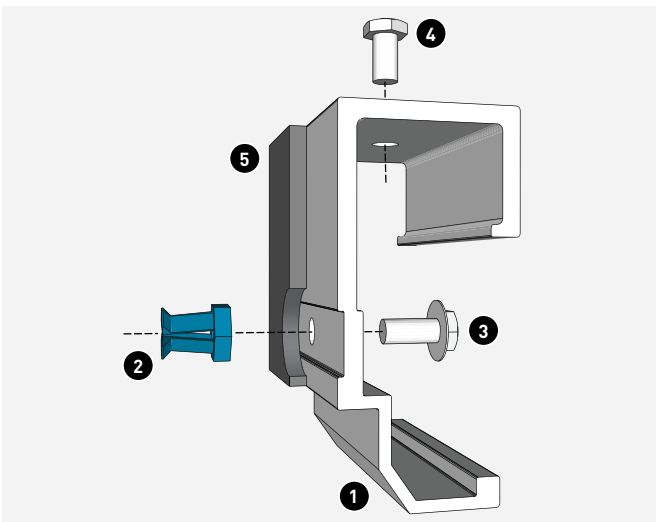
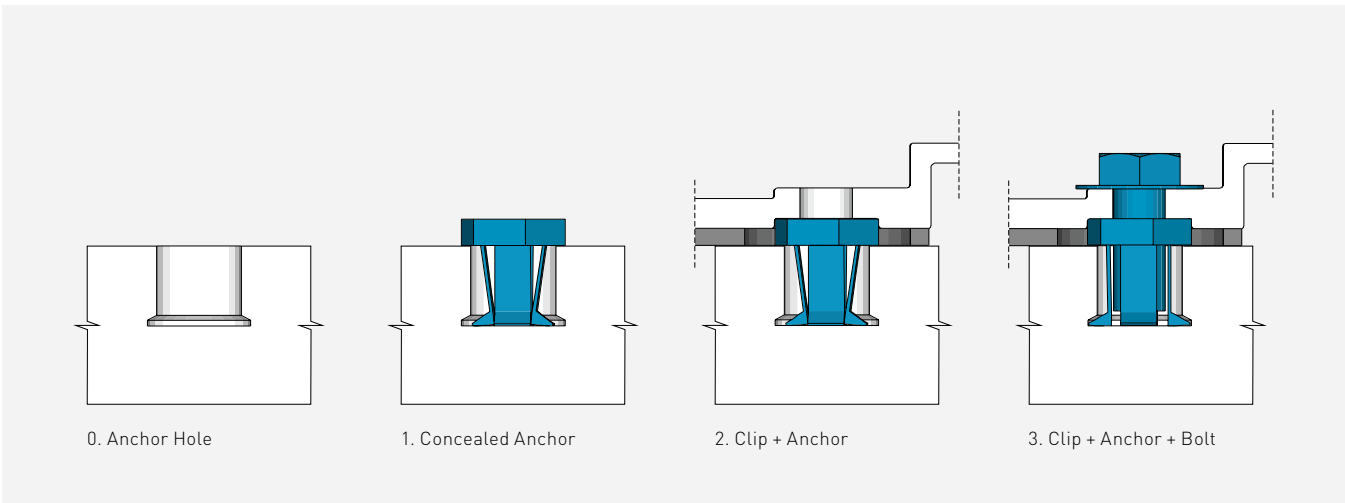

TAKTLHARDWARE is primarily used for exterior applications in back ventilated facade wall assemblies (rainscreen), with or without continuous exterior insulation. It is compatible with a wide range of sub-frame products:

- Close-cladding (without sub-girts) for concealed fixing both interior finishes and exterior cladding
- Ceiling and soffit conditions
- Sloped roof applications with appropriate detailing and support system engineering
- Large and heavy panels

For more information reference **TAKTLHARDWARE** Concealed Panel Attachment (Doc. SP34-1).

REQUIRED TOOLS AND EQUIPMENT

TAKTL Clips

Cordless Nut Driver / Ratche Wrench

CLIP INSTALLATION ELEMENTS

1. TAKTL Clip

2. Undercut Anchor

3. Attachment Bolt

4. Adjustment Bolt

5. Neoprene Pad (Crosscut)

Installing Clips on Pre-Drilled Panels

IMPORTANT



Before Working



Work on flat work surface with continuous support to prevent flexing. Do NOT span the panel across unsupported saw horses.



Panels should be stored on edge in a staging rack for ventilated drying.



Remember to maintain all TAKTL handling instructions while staging, moving, thoroughly drying and storing panels.

01 Clip Installation

Insert the undercut anchor into the hole in the panel (FIG. A).

A

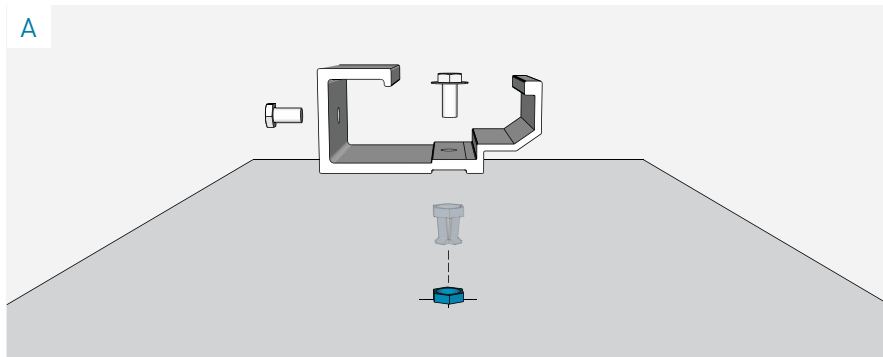

02 Clip Installation

Place clip over the anchor. Compress the clip to engage the anchor head with the clip channel so that the anchor cannot spin when the bolt is driven in (FIG. B).

B

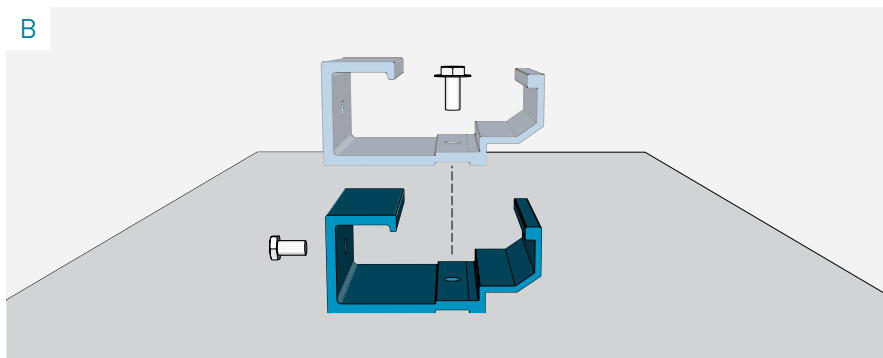

03 Clip Installation

Using a cordless nut driver or ratchet wrench, tighten the bolt until it is set tight to the clip (FIG. C).

C

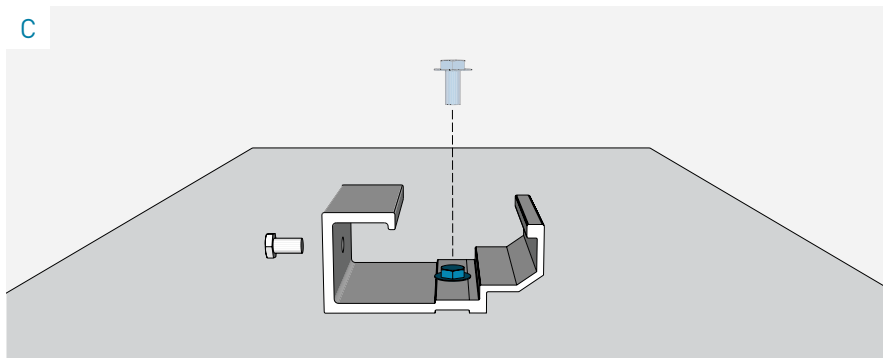

04 Clip Installation

Identify the top of the panel and install adjustment bolts set to 1/8in below the inner face of the rail wall (FIG. D).

NOTE: Proper coordination of the clip thickness, anchor depth and bolt length is required for a safe and structurally sound connection. Only anchors, bolts, and clips supplied by TAKTL shall be used.

D

